

DMS05N60

N-Channel Depletion-Mode MOSFET

Features

- Depletion Mode (Normally On)
- Advanced Planar Technology
- Rugged Poly-silicon Gate Cell Structure
- Fast Switching Speed
- ESD Sensitive.
- RoHS compliant package

Applications

- Normally-on Switches
- SMPS start-up Circuit
- Linear Amplifier
- Converters
- Constant Current Source
- Telecom

Package type : SOT-23

Packing & Order Information

3,000/Reel



**RoHS
COMPLIANT**

Graphic symbol

drain pin 3

gate
pin 1



source pin 2

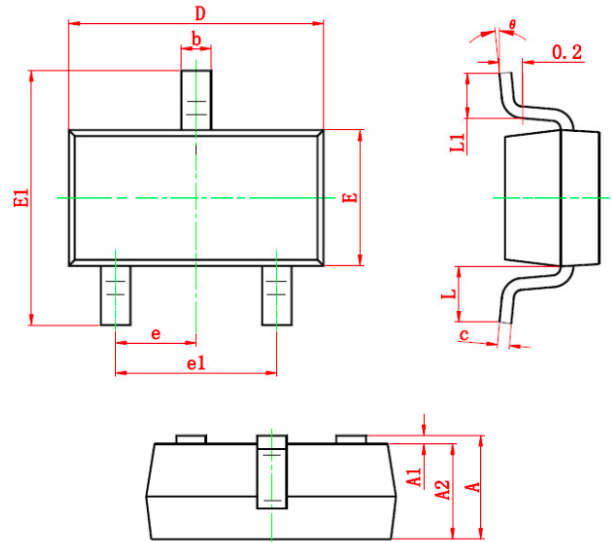

Symbol	Dimensions In Millimeters		Dimensions In Inches	
	Min	Max	Min	Max
A	0.900	1.200	0.035	0.043
A1	0.000	0.100	0.000	0.004
A2	0.900	1.100	0.035	0.039
b	0.300	0.500	0.012	0.020
c	0.080	0.150	0.003	0.006
D	2.800	3.000	0.110	0.118
E	1.200	1.400	0.047	0.055
E1	2.250	2.550	0.089	0.100
e	0.950 TYP		0.037 TYP	
e1	1.800	2.000	0.071	0.079
L	0.550 REF		0.022 REF	
L1	0.300	0.500	0.012	0.020
θ	0°	8°	0°	6°

DMS05N60

N-Channel Depletion-Mode MOSFET

MAXIMUM RATINGS AND ELECTRICAL CHARACTERISTICS

Absolute Maximum Ratings TA=25°C unless otherwise specified

Symbol	Parameter	DMS05N60	Unit
VDSX	Drain-to-Source Voltage ^[1]	600	V
VDGX	Drain-to-Gate Voltage ^[1]	600	V
ID	Continuous Drain Current	0.020	A
IDM	Pulsed Drain Current	0.081	A
PD	Power Dissipation	0.50	W
VGS	Gate-to-Source Voltage	±20	V
TL	Soldering Temperature	300	°C
	Distance of 1.6mm from case for 10 seconds		
TJ, TSTG	Operating and Storage Temperature Range	-55 to +150	

Caution: Stresses greater than those listed in the “Absolute Maximum Ratings “may cause permanent damage to the device.

Thermal Characteristics

Symbol	Parameter	DMS05N60	Unit
RθJA	Thermal Resistance, Junction to Ambient Air	250	K/W

OFF Characteristics TA=25°C unless otherwise specified

Symbol	Parameter	Conditions	Min	Tpy	Max.	Units
BVDSX	Drain-to-Source Breakdown Voltage	VGS=-5V, ID=250μA	600			V
ID(OFF)	Drain-to-Source Teakage Current	VDS=600V, VGS=-5V			0.1	μA
		VDS=600V, VGS=-5V TJ=125°C			10	μA
IGSS	Gate-to-Source Leakage Current	VGS=+20V, VDS=0V			100	nA
		VGS=-20V, VDS=0V			-100	nA

ON Characteristics TA=25°C unless otherwise specified

Symbol	Parameter	Conditions	Min	Tpy	Max.	Units
IDSS	Saturated Drain-to-Source Current	VGS=0V, VDS=25V	12			mA
RDS(ON)	Static Drain-to-Source On-Resistance	VGS=0V, ID=3Ma [4]		500	700	Ω
VGS(OFF)	Gate-to-Source Cut-off Voltage	VDS=3V, ID=8μA	-2.7		-1.5	V
gfs	Forward Transconductance	VDS=10V, ID=5mA		15.4		mS

DMS05N60

N-Channel Depletion-Mode MOSFET

Dynamic Characteristics Essentially independent of operating temperature

Symbol	Parameter	Conditions	Min	Tpy	Max.	Units
C _{ISS}	Input Capacitance	V _{GS} =-5V		12.3		pf
C _{OSS}	Output Capacitance	V _{DS} =25V		2.6		
C _{RSS}	Reverse Transfer Capacitance	f=1.0MHz		1.8		
Q _g	Total Gate Charge	V _{GS} =-5V~5V V _{DS} =300V, I _D =5mA		1.55		nC
Q _{gs}	Gate-to-Source Charge			0.12		
Q _{gd}	Gate-to-Drain (Miller) Charge			0.56		

Resistive Switching Characteristics Essentially independent of operating temperature

Symbol	Parameter	Conditions	Min	Tpy	Max.	Units
T _{d(ON)}	Turn-on Delay Time	V _{GS} =-5V~5V V _{DD} =300V, I _D =5Ma R _G =20Ohm		4		ns
T _{rise}	Rise Time			9		
t _{d(OFF)}	Turn-off Delay Time			14		
t _{fall}	Fall Time			84		

Resistive Switching Characteristics Essentially independent of operating temperature

Symbol	Parameter	Conditions	Min	Tpy	Max.	Units
V _{SD}	Diode Forward Voltage	I _{SD} =3.0mA, V _{GS} =-10V			1.2	V

NOTE:

[1] T_J=+25°C to +150°C

[2] Repetitive rating, pulse width limited by maximum junction temperature.

[3] Pulse width ≤ 380 μs ; duty cycle ≤ 2%

DMS05N60

N-Channel Depletion-Mode MOSFET

Characteristic Curves

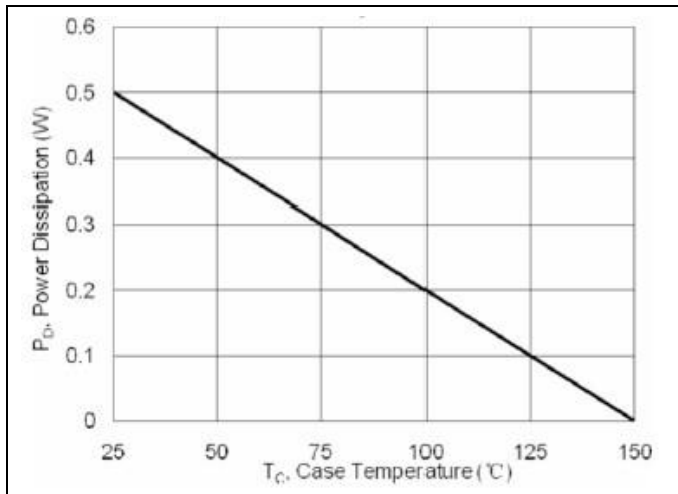

FIG.1 – MAXIMUM POWER DISSIPATION VS CASE TEMPERATURE

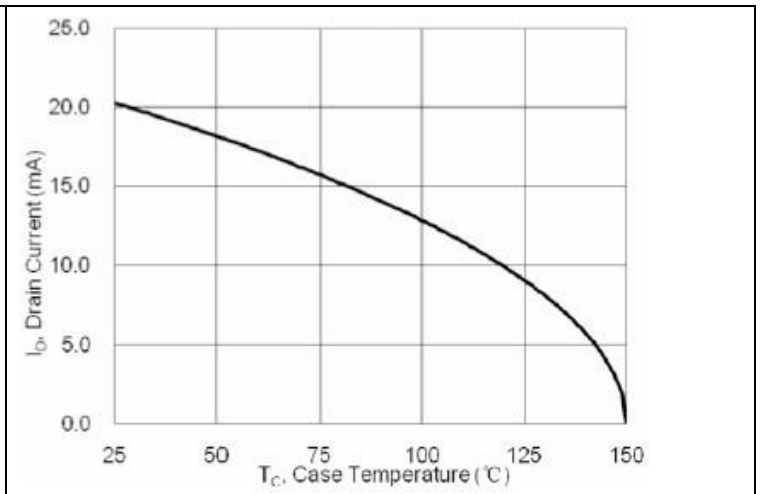

FIG.2 – MAXIMUM CONTINUOUS DRAIN CURRENT VS CASE TEMPERATURE

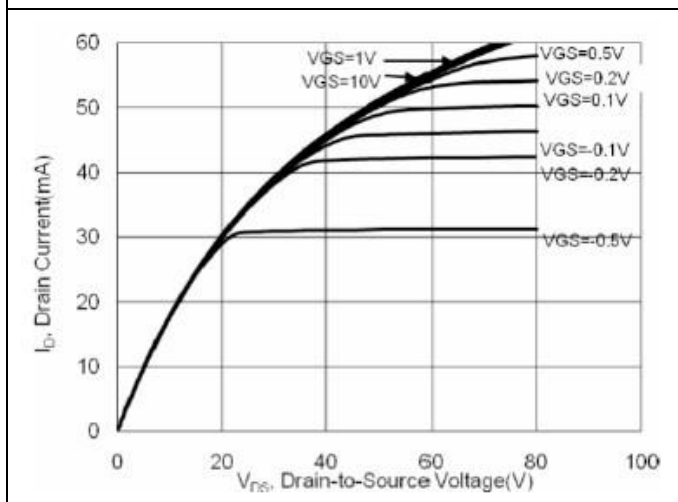

FIG.3 – TYPICAL OUTPUT CHARACTERISTICS

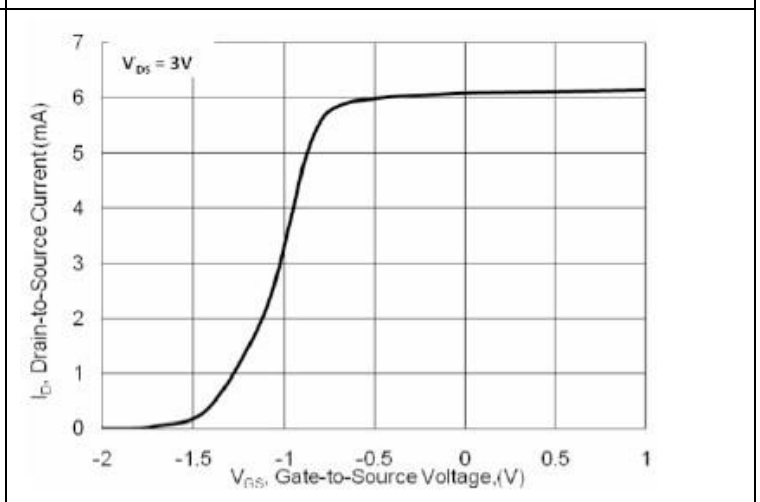

FIG.4 – TYPICAL TRANSFER CHARACTERISTICS

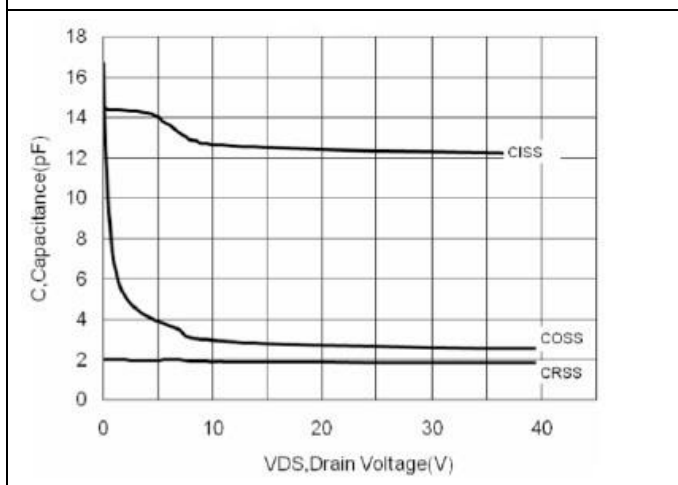

FIG.5 – TYPICAL CAPACITANCE VS. DRAIN-TO-SOURCE VOLTAGE

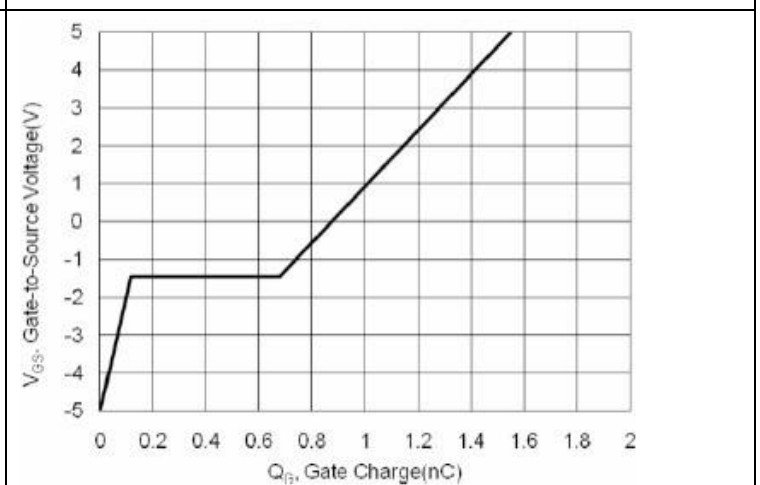

FIG.6 – TYPICAL GATE CHARGE VS GATE-TO-SOURCE VOLTAGE

DMS05N60

N-Channel Depletion-Mode MOSFET

Disclaimer

ALL PRODUCT, PRODUCT SPECIFICATIONS AND DATA ARE SUBJECT TO CHANGE

WITHOUT NOTICE TO IMPROVE RELIABILITY, FUNCTION OR DESIGN OR OTHERWISE.

Bruckewell Technology Inc., its affiliates, agents, and employees, and all persons acting on its or their behalf (collectively, "Bruckewell"), disclaim any and all liability for any errors, inaccuracies or incompleteness contained in any datasheet or in any other disclosure relating to any product.

Bruckewell makes no warranty, representation or guarantee regarding the suitability of the products for any particular purpose or the continuing production of any product. To the maximum extent permitted by applicable law, Bruckewell disclaims

- (i) Any and all liability arising out of the application or use of any product.
- (ii) Any and all liability, including without limitation special, consequential or incidental damages.
- (iii) Any and all implied warranties, including warranties of fitness for particular purpose, non-infringement and merchantability.

Statements regarding the suitability of products for certain types of applications are based on Bruckewell's knowledge of typical requirements that are often placed on Bruckewell products in generic applications.

Such statements are not binding statements about the suitability of products for a particular application. It is the customer's responsibility to validate that a particular product with the properties described in the product specification is suitable for use in a particular application. Parameters provided in datasheets and/or specifications may vary in different applications and performance may vary over time.

Product specifications do not expand or otherwise modify Bruckewell's terms and conditions of purchase, including but not limited to the warranty expressed therein.