

## BW3402

### N-Channel 30-V Enhancement-Mode MOSFETs

#### Mechanical Data

- Case: SOT-23 Molded plastic
- Epoxy: UL94V-O rate flame retardant
- RoHS compliant package

Package type : SOT-23

#### Packing & Order Information

3,000/Reel

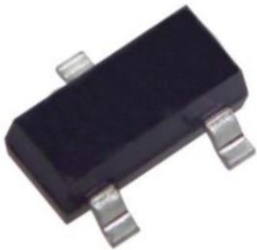

**RoHS  
COMPLIANT**

Graphic symbol

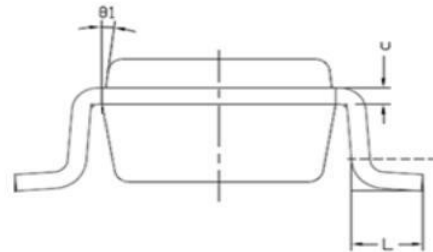
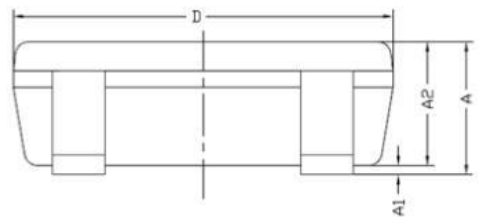
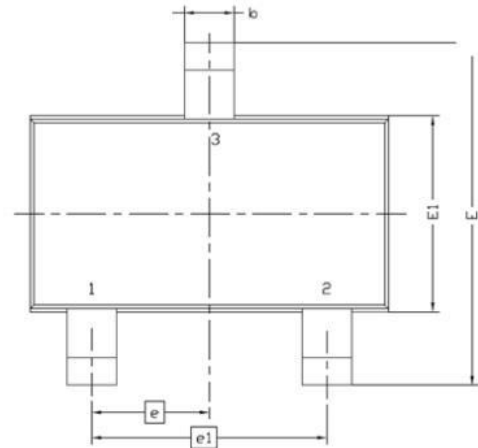
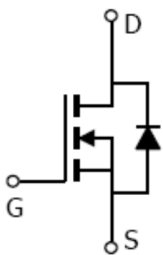
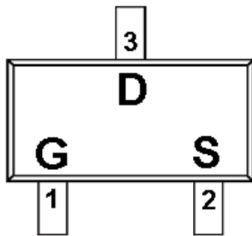

Symbol	MILLIMETERS	
	MIN	MAX
A	0.8	1.2
A1	0	0.1
A2	0.7	1.1
b	0.3	0.5
c	0.1	0.2
D	2.7	3.1
E	2.6	3
E1	1.4	1.8
e	0.95 BSC	
e1	1.9 BSC	
L	0.3	0.6
θ1	7° NOM	

## BW3402

### N-Channel 30-V Enhancement-Mode MOSFETs

#### MAXIMUM RATINGS AND ELECTRICAL CHARACTERISTICS

##### Maximum Ratings (Tc=25°C unless otherwise noted)

Parameter	Symbol	BW3402	Unit
Drain-Source Voltage	BV <sub>DSS</sub>	30	V
Gate- Source Voltage	V <sub>GS</sub>	12	V
Drain Current (continuous)	I <sub>D</sub>	4.6	A
Drain Current (pulsed)	I <sub>DM</sub>	16	A
Thermal resistance, junction to ambient air	PD	1380	mW
Junction	T <sub>J</sub>	150	°C
Storage Temperature	T <sub>STG</sub>	-55 to +150	°C

##### Maximum Ratings (Tc=25°C unless otherwise noted)

Parameter	Symbol	Min	Typ.	Max.	Units
Drain-Source Breakdown Voltage (I <sub>D</sub> = 250uA, V <sub>GS</sub> = 0 V)	BV <sub>DSS</sub>	30		--	V
Gate Threshold Voltage (I <sub>D</sub> = 250uA, V <sub>GS</sub> = V <sub>DS</sub> )	V <sub>GS(th)</sub>	0.7		18	V
Diode Forward Voltage Drop (I <sub>S</sub> = 1 A, V <sub>GS</sub> = 0 V)	V <sub>SD</sub>	--		1	V
Zero Gate Voltage Drain Current (V <sub>GS</sub> =0V, V <sub>DS</sub> = 24V) (V <sub>GS</sub> =0V, V <sub>DS</sub> = 24V, T <sub>A</sub> =55°C)	I <sub>DSS</sub>			1 5	uA

##### Maximum Ratings (Tc=25°C unless otherwise noted)

Parameter	Symbol	Min	Typ.	Max.	Units
Gate Body Leakage (V <sub>GS</sub> =+12 V, V <sub>DS</sub> = 0 V)	I <sub>GSS</sub>	--		+/-100	nA
Static Drain-Source On-State Resistance (I <sub>D</sub> = 4.6 A, V <sub>GS</sub> = 10 V)	R <sub>DS(ON)</sub>	--		30	mΩ
Static Drain-Source On-State Resistance (I <sub>D</sub> = 4 A, V <sub>GS</sub> = 4.5 V)		--		50	mΩ
Static Drain-Source On-State Resistance (I <sub>D</sub> = 1 A, V <sub>GS</sub> = 2.5 V)				100	pF
Input Capacitance (V <sub>GS</sub> = 0 V, V <sub>DS</sub> = 15 V, f = 1MHz)	C <sub>ISS</sub>		954	--	pF
Output Capacitance (V <sub>GS</sub> = 0 V, V <sub>DS</sub> = 15 V, f = 1MHz)	C <sub>OSS</sub>		115	--	pF
Turn-ON Time (V <sub>DS</sub> = 15 V, V <sub>GS</sub> = 10 V, R <sub>GEN</sub> = 6 Ω)	t(on)		6.3	--	ns
Turn-OFF Time (V <sub>DS</sub> = 15 V, V <sub>GS</sub> = 10 V, R <sub>GEN</sub> = 6 Ω)	t(off)	--	38.2	--	ns

Pulse Width<300μs; Duty Cycle<2.0%

## BW3402

### N-Channel 30-V Enhancement-Mode MOSFETs

#### Characteristics Curve

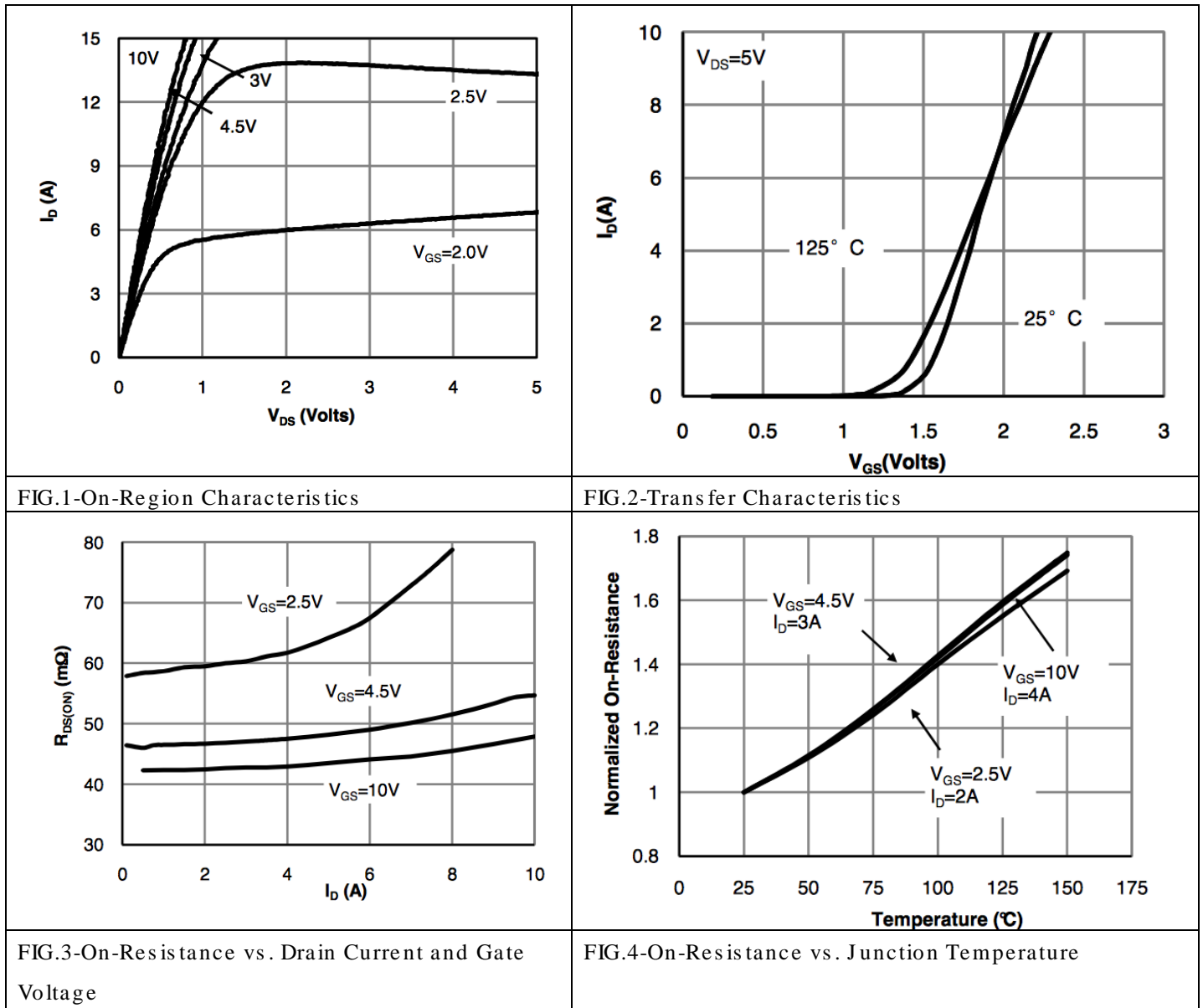

## BW3402

### N-Channel 30-V Enhancement-Mode MOSFETs

#### Characteristics Curves

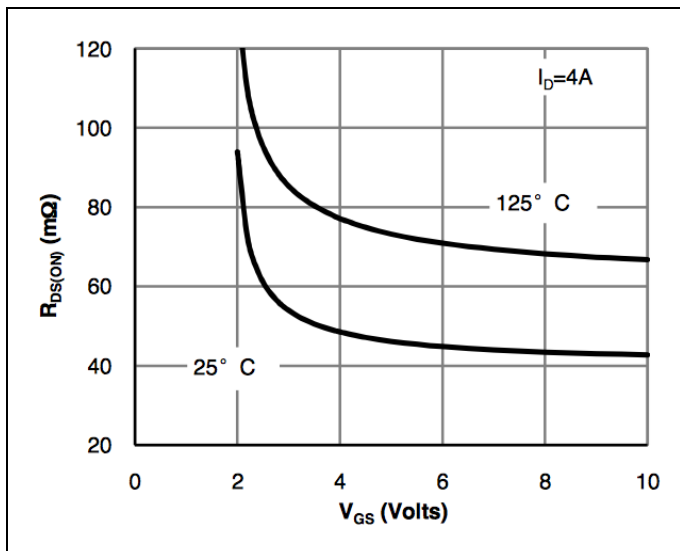

FIG.5-On-Resistance vs. Gate-Source Voltage

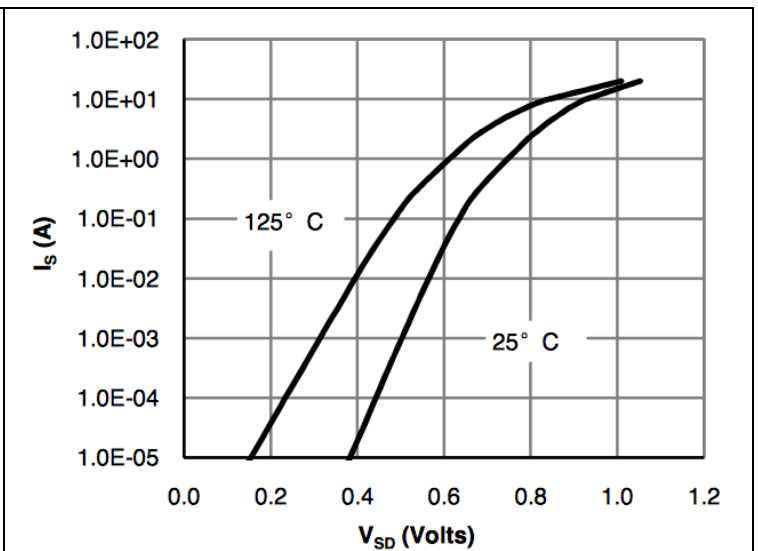

FIG.6-Body-Diode Characteristics

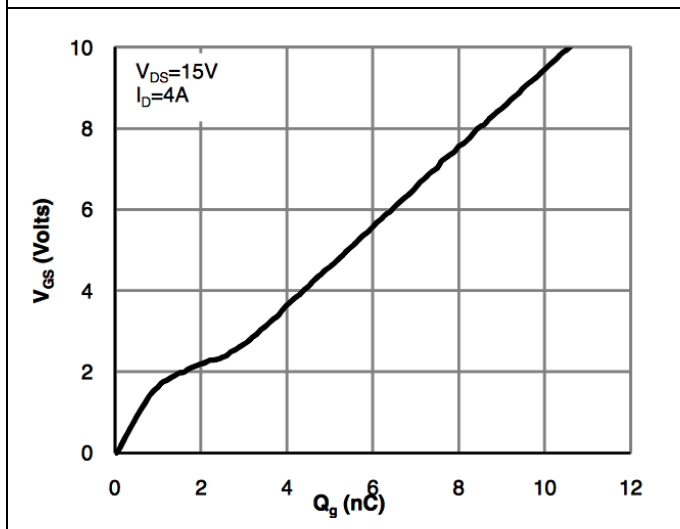

FIG.7-Gate-Charge Characteristics

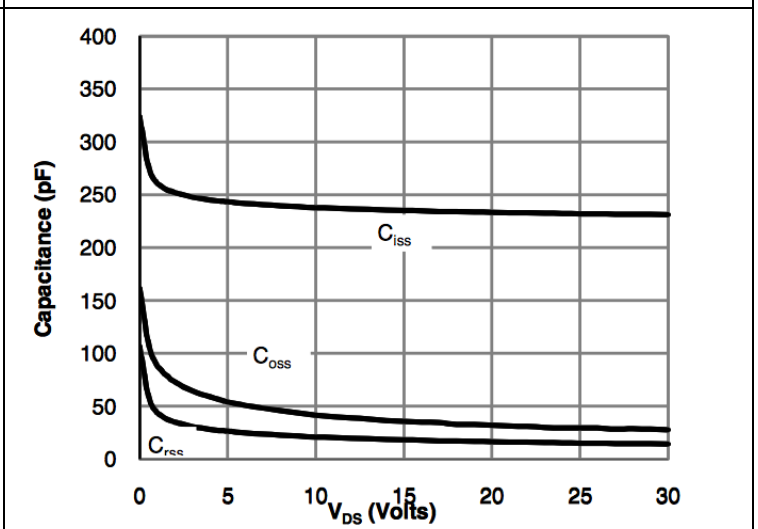

FIG.8-Capacitance Characteristics

## BW3402

### N-Channel 30-V Enhancement-Mode MOSFETs

ALL PRODUCT, PRODUCT SPECIFICATIONS AND DATA ARE SUBJECT TO CHANGE WITHOUT NOTICE TO IMPROVE RELIABILITY, FUNCTION OR DESIGN OR OTHERWISE.

Bruckewell Technology Inc., its affiliates, agents, and employees, and all persons acting on its or their behalf (collectively, "Bruckewell"), disclaim any and all liability for any errors, inaccuracies or incompleteness contained in any datasheet or in any other disclosure relating to any product. Bruckewell makes no warranty, representation or guarantee regarding the suitability of the products for any particular purpose or the continuing production of any product. To the maximum extent permitted by applicable law, Bruckewell disclaims

- (i) Any and all liability arising out of the application or use of any product.
- (ii) Any and all liability, including without limitation special, consequential or incidental damages.
- (iii) Any and all implied warranties, including warranties of fitness for particular purpose, non-infringement and merchantability.

Statements regarding the suitability of products for certain types of applications are based on Bruckewell's knowledge of typical requirements that are often placed on Bruckewell products in generic applications.

Such statements are not binding statements about the suitability of products for a particular application. It is the customer's responsibility to validate that a particular product with the properties described in the product specification is suitable for use in a particular application. Parameters provided in datasheets and/or specifications may vary in different applications and performance may vary over time.

Product specifications do not expand or otherwise modify Bruckewell's terms and conditions of purchase, including but not limited to the warranty expressed therein.