

BC846A-BC848C

NPN SURFACE MOUNT SMALL SIGNAL TRANSISTOR IN SOT23

Features

- Ideally Suited for Automatic Insertion
- Complementary PNP Types Available
- For switching and AF Amplifier
- RoHS compliant package

Mechanical Data

- Case: SOT-23 Molded plastic
- Epoxy: UL94V-O rate flame retardant

Packing & Order Information

3,000/Reel

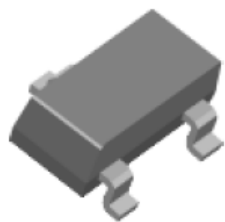

**RoHS
COMPLIANT**

Graphic symbol

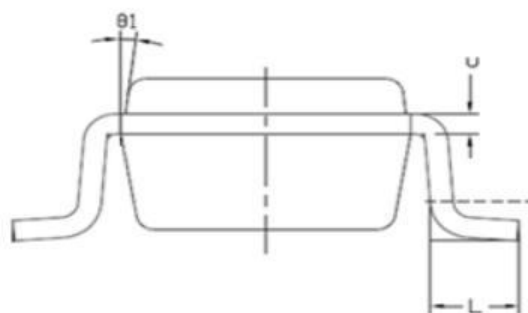
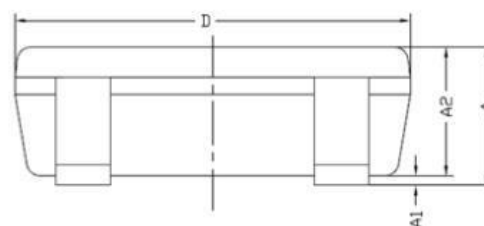
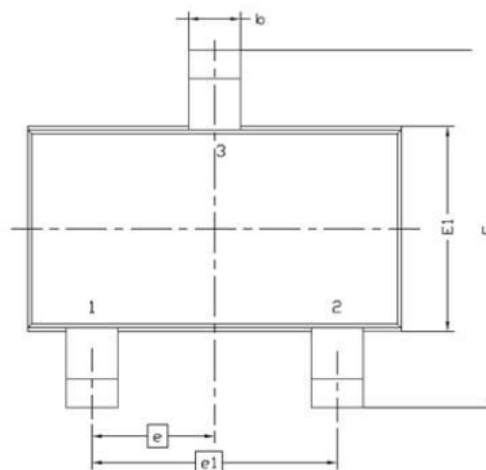
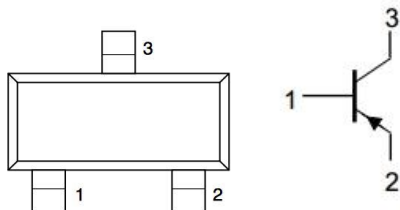

| Symbol | MILLIMETERS | |
|--------|-------------|-----|
| | MIN | MAX |
| A | 0.8 | 1.2 |
| A1 | 0 | 0.1 |
| A2 | 0.7 | 1.1 |
| b | 0.3 | 0.5 |
| c | 0.1 | 0.2 |
| D | 2.7 | 3.1 |
| E | 2.6 | 3 |
| E1 | 1.4 | 1.8 |
| e | 0.95 BSC | |
| e1 | 1.9 BSC | |
| L | 0.3 | 0.6 |
| theta1 | 7° NOM | |

BC846A-BC848C

NPN SURFACE MOUNT SMALL SIGNAL TRANSISTOR IN SOT23

MAXIMUM RATINGS AND ELECTRICAL CHARACTERISTICS

Maximum Ratings (Tc=25°C unless otherwise noted)

| Symbol | Parameter | BC846A,B | BC847A,B | BC848A,B,C | Unit |
|--------|------------------------------|----------|----------|------------|------|
| VCEO | Collector-Emitter Voltage | 65 | 45 | 30 | Vdc |
| VCBO | Collector-Base Voltage | 80 | 50 | 30 | Vdc |
| VEBO | Emitter-Base Voltage | 6 | 6 | -5 | Vdc |
| Ic | Collector Current Continuous | 100 | 100 | 100 | mAdc |

THERMAL CHARACTERISTICS

| Symbol | Parameter | Max | Unit |
|-------------|--|------------|-------|
| PD(Ta=25°C) | Total Device Dissipation | 225 | mW |
| | FR-5 Board(1), TA=25° Derate above 25° | 1.8 | mW/°C |
| PD(Ta=25°C) | Total Device Dissipation | 300 | mW |
| | Alumina Substrate, TA=25° Derate above 25° | 2.4 | mW/°C |
| RθJA | Thermal Resistance Junction to Ambient | 80 | V |
| TJ ,Tstg | Junction and Storage Temperature | 55 to +150 | °C |

Electrical characteristics (Tc=25°C unless otherwise noted)

OFF CHARACTERISTICS

| Symbol | Parameter | | MIN | TYP | MAX | UNIT |
|----------|--|------------|-----|-----|-----|------|
| V(BR)CEO | Collector-Emitter Breakdown Voltage (Ic=-10mAdc,IB=0) | BC846A,B | 65 | | | V |
| | | BC847A,B | 45 | | | V |
| | | BC848A,B,C | 30 | | | V |
| V(BR)CBO | Collector-Base Breakdown Voltage (Ic=-10μAdc,IE=0) | BC846A,B | 80 | | | V |
| | | BC847A,B | 50 | | | V |
| | | BC848A,B,C | 30 | | | V |
| V(BR)EBO | Emitter-Base Breakdown Voltage (IE=-10μAdc,Ic=0) | BC846A,B | 6 | | | V |
| | | BC847A,B | 6 | | | V |
| | | BC848A,B,C | 5 | | | V |
| IBO | Collector Cutoff Current V | | | | | V |
| | (VCB=-30v) | | | | 15 | nA |
| | (VcB=-30Vdc,TA=150°C) | | | | 5 | uA |

BC846A-BC848C

NPN SURFACE MOUNT SMALL
SIGNAL TRANSISTOR IN SOT23

ON CHARACTERISTICS

| Symbol | Parameter | | MIN | TYP | MAX | UNIT |
|------------|--------------------------------------|------------|-----|-----|------|------|
| VCE(sat) | Collector-Emitter Saturation Voltage | | | | | V |
| | (Ic=10mA, IB=-0.5mA) | | | | 0.25 | V |
| | (Ic=100mA, IB=-5.0mA) | | | | 0.6 | V |
| HFE | DC Current Gain | BC846A,B | | 90 | | |
| | (Ic=10μA, VCE=-5.0V) | BC847A,B | | 150 | | |
| | | BC848A,B,C | | 270 | | |
| | (Ic=2.0mA, VCE=-5.0V) | BC846A,B | 125 | 180 | 250 | |
| | | BC847A,B | 220 | 290 | 475 | |
| BC848A,B,C | | 420 | 520 | 800 | | |
| VBE(sat) | Base-Emitter Saturation Voltage | | | | | V |
| | (Ic=10mA, IB=-0.5mA) | | | 0.7 | | V |
| | (Ic=100mA, IB=-5.0mA) | | | 0.9 | | V |
| VBE(on) | Base-Emitter Voltage | | | | | V |
| | (Ic=2.0mA, VCE=-5.0V) | | 580 | 660 | 700 | mV |
| | (Ic=10mA, VCE=-5.0V) | | | | 770 | mV |

ON CHARACTERISTICS

| Symbol | Parameter | | MIN | TYP | MAX | UNIT |
|--------|---|--|-----|-----|-----|------|
| fT | Current-Gain-Bandwidth Product (Ic=10mA, VCE=-5.0V, f=100MHz) | | 100 | | | MHz |
| Cobo | Output Capacitance (VCB=-10V, IE=0, f=1.0MHz) | | | | 4.5 | pF |
| NF | Noise Figure (VCE=-5.0V, IC=200μA, Rs=2.0kΩ, f=1.0KHz, BW=200Hz) | | | | 10 | dB |

DEVICE MARK

| | |
|--------|----|
| BC846A | 1A |
| BC846B | 1B |
| BC847A | 1E |
| BC847B | 1F |
| BC848A | 1J |
| BC848B | 1K |
| BC848C | |

BC846A-BC848C

NPN SURFACE MOUNT SMALL SIGNAL TRANSISTOR IN SOT23

RATINGS AND CHARACTERISTIC CURVES

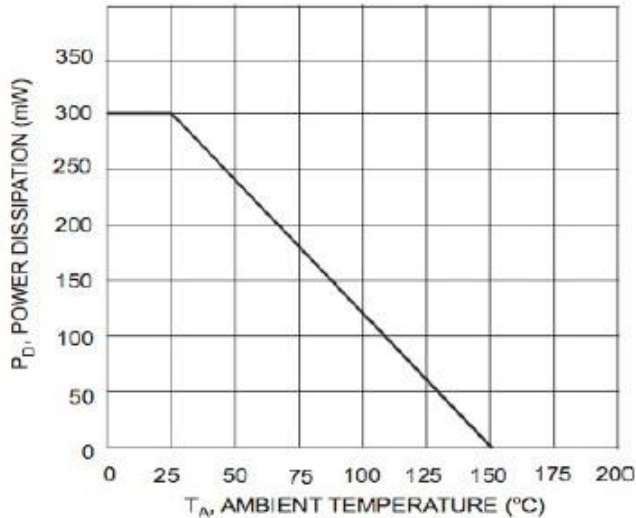

Fig. 1, Max Power Dissipation vs Ambient Temperature

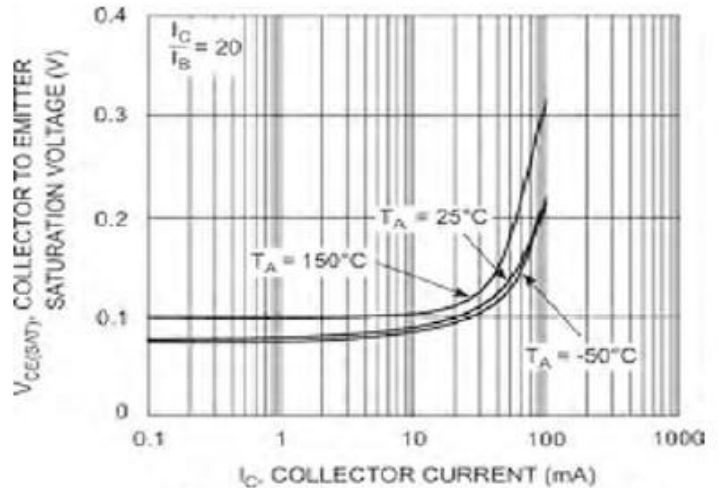

Fig. 2, Collector Emitter Saturation Voltage vs. Collector Current

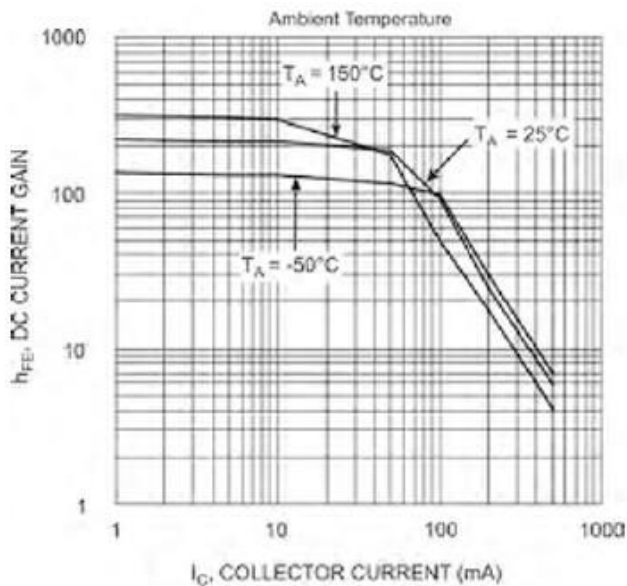

Fig. 3, DC Current Gain vs. Collector Current

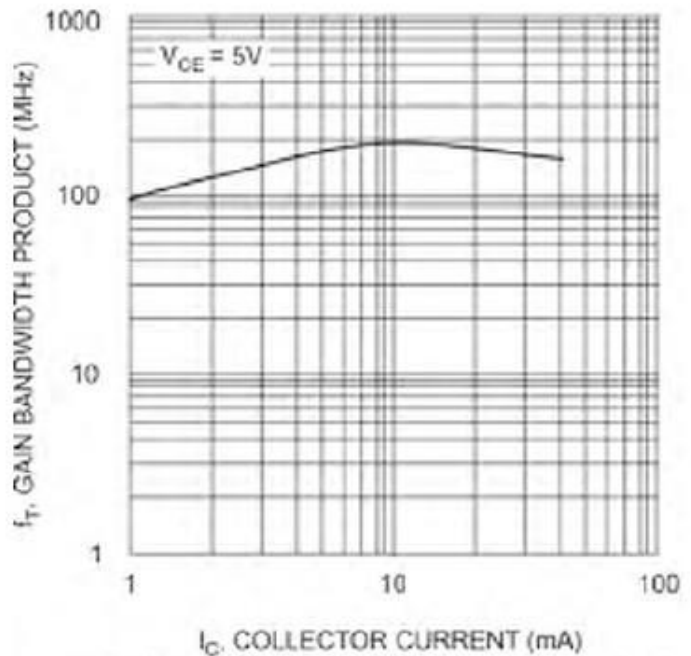

Fig. 4, Gain Bandwidth Product vs Collector Current

BC846A-BC848C

NPN SURFACE MOUNT SMALL SIGNAL TRANSISTOR IN SOT23

Disclaimer

ALL PRODUCT, PRODUCT SPECIFICATIONS AND DATA ARE SUBJECT TO CHANGE WITHOUT NOTICE TO IMPROVE RELIABILITY, FUNCTION OR DESIGN OR OTHERWISE.

Bruckewell Technology Inc., its affiliates, agents, and employees, and all persons acting on its or their behalf (collectively, "Bruckewell"), disclaim any and all liability for any errors, inaccuracies or incompleteness contained in any datasheet or in any other disclosure relating to any product. Bruckewell makes no warranty, representation or guarantee regarding the suitability of the products for any particular purpose or the continuing production of any product. To the maximum extent permitted by applicable law, Bruckewell disclaims

- (i) Any and all liability arising out of the application or use of any product.
- (ii) Any and all liability, including without limitation special, consequential or incidental damages.
- (iii) Any and all implied warranties, including warranties of fitness for particular purpose, non-infringement and merchantability.

Statements regarding the suitability of products for certain types of applications are based on Bruckewell's knowledge of typical requirements that are often placed on Bruckewell products in generic applications.

Such statements are not binding statements about the suitability of products for a particular application. It is the customer's responsibility to validate that a particular product with the properties described in the product specification is suitable for use in a particular application. Parameters provided in datasheets and/or specifications may vary in different applications and performance may vary over time.

Product specifications do not expand or otherwise modify Bruckewell's terms and conditions of purchase, including but not limited to the warranty expressed therein.